

SECTION K-K

NOZZLE SCHEDULE

MARK	QTY	SIZE / RATING	DESCRIPTION
N1	1	4" 150# RFSO	INLET
N2	1	4" 150# RFSO	OUTLET
N3	2	1/2" 3000# NPT	PRESSURE GAUGE
N4	1	1/2" 3000# NPT	VENT
N5	1	1" 3000# NPT	CLEAN DRAIN
N6	1	1" 3000# NPT	DIRTY DRAIN

VESSEL DESIGN CONDITIONS

CODE: BEST COMMERCIAL PRACTICE		
M.A.W.P.:	150 PSI @ 400°F	GASKET: BUNA-N
M.A.E.P.:	FV PSI @ 400°F	
M.D.M.T.:	-20° F @ 150 PSI	
HYDROTEST PRESS:	195 PSI	
MATERIAL:	SS316	

NOTES:

1. VESSEL DRY WEIGHT: **358 LBS.**
2. SHIPPING WEIGHT: **550 LBS.**
3. FLOODED WEIGHT: **745 LBS.**
4. VESSEL VOLUME: **5.85 CU. FT.**
5. VESSEL WILL HOUSE (QTY=25) 2.5"OD x 40" LG CARTRIDGE.

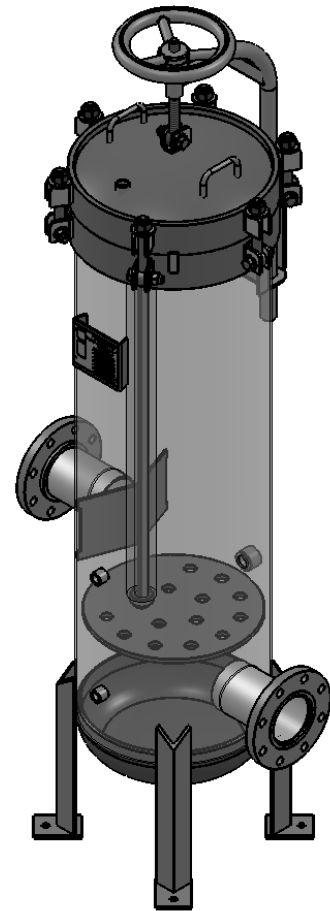

APPROVED WITH MARK-UPS APPROVED

THIRD ANGLE PROJECTION
TOLERANCES-UNLESS OTHERWISE NOTED
DECIMAL .X = ±.1" .XX = ±.02" .XXX = ±.005"
FRACTIONAL = ±1/8"
ANGULAR = ± 1°
MAX. MACHINED SURFACE FINISH 125/√

FIL-TREK CORPORATION
 55 Stafford Court
 Cambridge, Ontario
 N1T 1B3
 Canada
 Phone: (519) 623-7448
 Fax: (519) 623-8807
 Email: info@fil-trek.com
 Website: www.fil-trek.com

THIS DRAWING IS THE PROPERTY OF 'FIL-TREK CORPORATION' AND MUST NOT BE COPIED OR USED IN ANY WAY DETRIMENTAL TO THE CORPORATION

EQUIPMENT: EGL SERIES (BAG FILTER VESSEL)

MODEL NO: S6EGL16-025-4-4F-150

CUSTOMER:

PARENT: NEW	DRAWN: JN	DATE: 23/06/2017	SERIAL No.	Part No. 001022-00078	REV. No. 0
CHK'D:	SCALE: NTS				