

NOZZLE SCHEDULE			
MARK	QTY	SIZE / RATING	DESCRIPTION
N1	1	8" 150# RFSO	INLET
N2	1	8" 150# RFSO	OUTLET
N3	2	1/2" 3000# NPT	PRESSURE GAUGE
N4	1	1/2" 3000# NPT	VENT
N5	1	2" 3000# NPT	CLEAN DRAIN
N6	1	2" 3000# NPT	DIRTY DRAIN

VESSEL DESIGN CONDITIONS	
CODE:	ASME SECTION VIII DIV. 1, 2019 EDITION
M.A.W.P.:	150 PSI @ 400°F
M.D.M.T.:	-50° F @ 150 PSI
M.A.W.P.:	FV PSI @ 400°F
CORROSION ALLOWANCE:	NONE
HYDROTEST PRESS:	210 PSI
STAMP:	U
SERVICE:	UNK LIQUID, NON LETHAL
PWHT:	N/A
RADIOGRAPHY:	N/A
MATERIAL:	SS316
GASKET:	BUNA-N

- NOTES:
- VESSEL WILL HOUSE (QTY=60) 2.5"OD x 40" LG DOE CARTRIDGE.
 - VESSEL DRY WEIGHT: **864.59** LBS.
 - SHIPPING WEIGHT: 1050 LBS.
 - FLOODED WEIGHT: **1880** LBS.
 - VESSEL VOLUME: **18.55** FT³

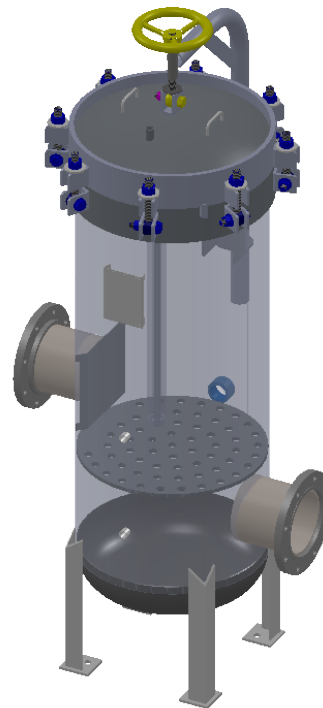

APPROVED WITH MARK-UPS APPROVED

<p>THIRD ANGLE PROJECTION</p> <p>TOLERANCES-UNLESS OTHERWISE NOTED</p> <p>DECIMAL .X = ±.1" .XX = ±.02" .XXX = ±.005"</p> <p>FRACTIONAL = ±1/8"</p> <p>ANGULAR = ± 1°</p> <p>MAX. MACHINED SURFACE FINISH 125 √</p>	<p>FIL-TREK CORPORATION</p> <p>55 Stafford Court Cambridge, Ontario N1T 1B3 Canada</p> <p>Phone: (519) 623-7448 Fax: (519) 623-8807 Email: info@fil-trek.com Website: www.fil-trek.com</p>	
	<p>THIS DRAWING IS THE PROPERTY OF 'FIL-TREK CORPORATION' AND MUST NOT BE COPIED OR USED IN ANY WAY DETRIMENTAL TO THE CORPORATION</p> <p>EQUIPMENT: GL SERIES (CARTRIDGE FILTER VESSEL)</p> <p>MODEL NO: S6GL24-060-4-8F-150</p> <p>CUSTOMER:</p>	
<p>PARENT: NEW DESIGN</p> <p>CHK'D: JN</p>	<p>DRAWN: NV</p> <p>DATE: 20/10/2020</p> <p>SCALE: NTS</p>	<p>SERIAL No.</p> <p>Part No. 001001-00149</p>
		<p>REV. No. 0</p>