

NOZZLE SCHEDULE			
MARK	QTY	SIZE / RATING	DESCRIPTION
N1	1	2" 150# NPT	INLET
N2	1	2" 150# NPT	OUTLET
N3	2	1/2" 3000# NPT	PRESSURE GAUGE
N4	1	1/2" 3000# NPT	VENT
SPARE	1	2" 150# NPT	SPARE

VESSEL DESIGN CONDITIONS	
CODE: BEST COMMERCIAL PRACTICE	
M.A.W.P.:	150 PSI @ 400°F
M.A.W.P.:	FV PSI @ 400°F
M.D.M.T.:	-50° F @ 150 PSI
HYDROTEST PRESS:	210 PSI
MATERIAL:	SS316

- NOTES:
1. VESSEL WILL HOUSE (QTY=1) DOUBLE LENGTH BASKET.
 2. DRY WEIGHT: 87 LBS
 3. FLOODED WEIGHT: 155 LBS
 4. SHIPPING WEIGHT: 100 LBS
 5. VESSEL VOLUME: 1 FT³

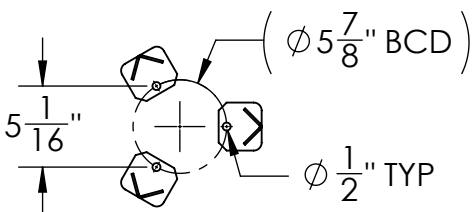
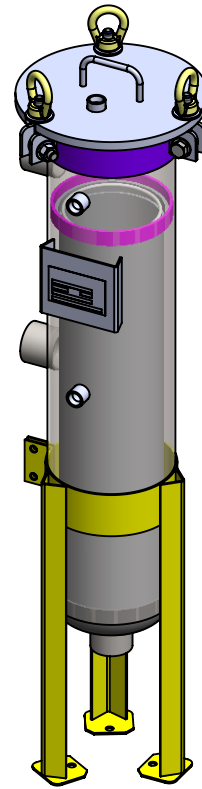

SECTION A-A
SCALE 1 : 12

APPROVED WITH MARK-UPS <input type="checkbox"/>		APPROVED <input type="checkbox"/>	
 THIRD ANGLE PROJECTION		 FIL-TREK CORPORATION	
TOLERANCES-UNLESS OTHERWISE NOTED DECIMAL .X = ±.1" .XX = ±.02" .XXX = ±.005" FRACTIONAL = ±1/8" ANGULAR = ± 1° MAX. MACHINED SURFACE FINISH 125 ✓		55 Stafford Court Cambridge, Ontario N1T 1B3 Canada Phone: (519) 623-7448 Fax: (519) 623-8807 Email: info@fil-trek.com Website: www.fil-trek.com	
THIS DRAWING IS THE PROPERTY OF 'FIL-TREK CORPORATION' AND MUST NOT BE COPIED OR USED IN ANY WAY DETRIMENTAL TO THE CORPORATION			
EQUIPMENT:		ESL SERIES (BAG FILTER HOUSING)	
MODEL NO:		S6ESL112-2P-SW-CD-150	
CUSTOMER:			
PARENT: NEW DESIGN	DRAWN: JN	DATE: 03/04/19	SERIAL No. Part No. 002001-18522
	CHK'D: JP	SCALE: NTS	REV. No. 0