



DGF SERIES

Dry Gas Filtration

- Vertical Orientation
- Compact Design
- ASME Design

Ideal for removing dirt, pipe scale and other foreign matter from flowing gas lines in commercial and industrial applications.



SUITABLE USES



Air & Gas

MEDIA Accepts single or two stacked 6", 8", 12" or 14" OD filters
**Replacement cartridges available in Pleated Paper, Polyester, Fiberglass and Paper/microglass blend.*

COMPATIBLE FILTERS DGF Filters

RATINGS 150, 300, 600, 900 ANSI

AVAILABLE MATERIALS CS, SS304, SS316
**Low temp material available as an option*

ADDITIONAL FEATURES Using a pleated cellulose fiber elements to maximize filtration area and offering benefits such as reduced downtime, extended meter life, and improved measurement accuracy.

Custom sizes, configurations, materials of construction and other options may be available. Please contact Fil-Trek

For more information, e-mail: info@fil-trek.com or visit Fil-Trek.com

DGF SERIES

Vertical Dry Gas Filter

- Compact Design
- Vertical Orientation
- ASME Design

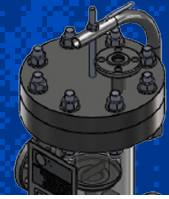

HOUSING SPECIFICATIONS

Inlet/Outlet	F - Flange BW - Butt Weld
Drain	¾" NPT Plugged 1" Flanged 2" Flanged
Vent	¾" NPT Plugged 1" NPT Plugged 1" Flanged
Gauges	½" NPT on all sizes
Closure and Headlift	K20 - Thru Bolt w/ Davit K22 - Thru Bolt w/ Side Hydraulic Jack K24 - Thru Bolt w/ Pogo K28 - Thru Bolt w/ Lungs Only K41 - Vertical High Pressure QOC - Sypris K43 - Vertical High Pressure QOC - TwinLock
Legs	Iron Tripod Legs
Gasket Options	Buna N, Viton, Vegetable fiber, Spiral Wound, and more

A Side in/side out*

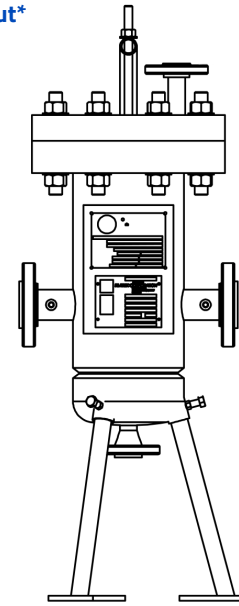

MODEL	VENT	DRAIN	COVER	COVER LIFTING	CLEARANCE FOR ELEMENT REMOVAL
DGF-175 2" & 3"	3/4" NPT PLUGGED	3/4" NPT PLUGGED	PLATE	HANDLES	9"
DGF-175 4" & 6"	3/4" NPT PLUGGED	3/4" NPT PLUGGED	PLATE	HANDLES	9"
DGF-150 2" & 3"	3/4" NPT PLUGGED	3/4" NPT PLUGGED	PLATE	HANDLES	9"
DGF-150 4" & 6"	3/4" NPT PLUGGED	3/4" NPT PLUGGED	PLATE	HANDLES	9"
DGF-150 8", 10" & 12"	3/4" NPT PLUGGED	3/4" NPT PLUGGED	PLATE	MECHANICAL DAVIT	14"/18"/22"
DGF-300 2" & 3"	3/4" NPT PLUGGED	3/4" NPT PLUGGED	PLATE	MECHANICAL DAVIT	9"
DGF-300 4" & 6"	3/4" NPT PLUGGED	3/4" NPT PLUGGED	PLATE	MECHANICAL DAVIT	9"
DGF-300 8", 10" & 12"	3/4" NPT PLUGGED	3/4" NPT PLUGGED	PLATE	MECHANICAL DAVIT	14"/18"/22"
DGF-600 2" & 3"	1" FLANGED	1" FLANGED	PLATE	MECHANICAL DAVIT	9"
DGF-600 4" & 6"	1" FLANGED	2" FLANGED	PLATE	MECHANICAL DAVIT	9"
DGF-600 8", 10" & 12"	1" FLANGED	2" FLANGED	PIATE	MECHANICAL DAVIT	14"/18"/22"
DGF-900 2" & 3"	1" FLANGED	1" FLANGED	PLATE	MECHANICAL DAVIT	9"
DGF-900 4" & 6"	1" FLANGED	1" FLANGED	PLATE	MECHANICAL DAVIT	9"
DGF-900 8", 10" & 12"	1" FLANGED	2" FLANGED	PIATE	MECHANICAL DAVIT	14"/18"/22"

DGF SERIES

Vertical Dry Gas Filter

- Compact Design
- Vertical Orientation
- ASME Design

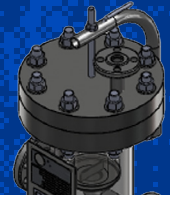

MODEL DIMENSIONAL DETAILS

MODEL	Figure	WEIGHT (LBS)	A	B	C	D	E
DGF-2-175	1	48	13 3/8	3 5/8	14	17	7
DGF-3-175	1	52	18 3/8	4 3/8	15	22 3/4	7
DGF-4-175	2	180	15 3/4	5	18	20 3/4	10 3/4
DGF-6-175	2	232	26 1/2	6	18	32 1/2	10 3/4
DGF-2-150	2	80	13 3/4	3 1/2	16	17 1/4	8 5/8
DGF-3-150	2	85	18 3/4	4	16	22 3/4	8 5/8
DGF-4-150	2	180	15 3/4	5	18	20 3/4	10 3/4
DGF-6-150	2	265	26 1/2	6	18	32 1/2	10 3/4
DGF-8-150	4	825	28 1/4	30	28	58 1/4	16
DGF-10-150	4	910	46 1/4	30	28	76 1/4	16
DGF-12-150	4	1100	48 3/4	32	30	80 3/4	18
DGF-2-300	3	295	14 1/4	22	16	36 1/4	8 5/8
DGF-3-300	3	330	19 1/4	23	16	42 1/4	8 5/8
DGF-4-300	3	380	16 1/2	27	20	43 1/2	10 3/4
DGF-6-300	3	480	27 1/4	30	20	57 1/4	10 3/4
DGF-8-300	4	1450	29 1/4	30	28	59 1/4	16
DGF-10-300	4	1650	47 1/4	30	28	77 1/4	16
DGF-12-300	4	1950	49 1/2	32	30	81 1/2	18
DGF-2-600	3	380	14 3/4	23	17	37 3/4	8 5/8
DGF-3-600	3	410	19 3/4	23	17	42 3/4	8 5/8
DGF-4-600	3	585	17 1/4	27	20	44 1/4	8 5/8
DGF-6-600	3	775	28	30	20	58	10 3/4
DGF-8-600	4	2275	30 1/2	30	28	60 1/2	16
DGF-10-600	4	2550	48 1/2	30	28	78 1/2	16

CHART LEGEND

- A** INLET TO TOP
- B** FLOOR TO INLET
- C** FACE TO FACE
- D** OVERALL HEIGHT
- E** OUTSIDE DIAMETER

Figure 1

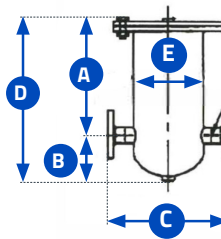

Figure 2

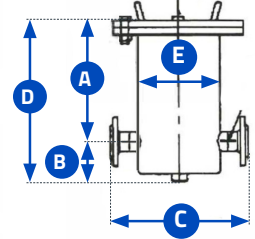

Figure 3

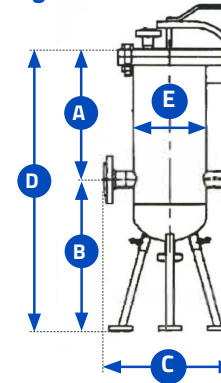
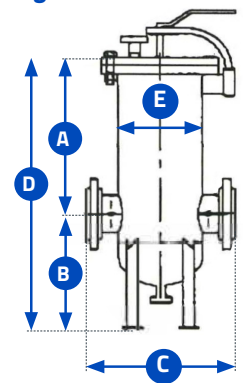

Figure 4



HOUSING PRODUCT NOMENCLATURE

S6	DGF-150	2F	150	K20	-
MOC	MODEL	CONNECTION TYPE	DESIGN PRESSURE	HEADLIFT	OPTIONS
(-) CS S4 SS304 S6 SS316	See Table	See "Housing Options"	150 175 300 600 900	See "Housing Options"	See "Housing Options"

DGF SERIES

Vertical Dry Gas Filter

- Compact Design
- Vertical Orientation
- ASME Design

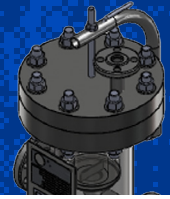

ELEMENT SPECIFICATIONS

DIMENSIONS

Outside Diameter	6"
	8"
	12"
	14"
Inside Diameter	3.875"
	5.75"
	10"
	12.125"
Available Lengths	3.75", 8.5", 17.5"
Media	Accepts single or two stacked 6", 8", 12" or 14" OD filters <i>*Replacement cartridges available in Pleated Paper, Polyester, Fiberglass and Paper/microglass blend.</i>
Micron Ratings	1, 5, 10, 25, 50

FILTER ELEMENT SPECIFICATION

HOUSING	OUTSIDE DIAMETER	LENGTH	INSIDE DIAMETER	NO. REQ.	PART NO. 10 MICRON
DGF-2	6"	8 1/2"	3 7/8"	1	005033-00001
DGF-3	6"	8 1/2"	3 7/8"	1	005033-00001
and	6"	*3 3/4"	3 7/8"	2	005033-00002
DGF-4	8"	8 1/2"	5 3/4"	1	005033-00003
DGF-6	8"	*8 1/2"	5 3/4"	2	005033-00003
DGF-8	12"	17 1/2"	10"	1	005033-00004
DGF-10	12"	*17 1/2"	10"	2	005033-00004
DGF-12	14"	*17 1/2"	12 1/8"	2	005033-00006

*Stacked



Dry Gas Filter

ELEMENT PRODUCT NOMENCLATURE

DGF	PE	0603	10	VI
MODEL	MEDIA	OUTSIDE/LENGTH	MICRON RATING	GASKET
DGF - Dry Gas Filter	Blank - Resin Impregnated Cellulose PE - Polyester	0603 - 6" OD / 3.75" Length 0608 - 6" OD / 8.5" Length 0808 - 8" OD / 8.5" Length 1217 - 12" OD / 17.5" Length 1417 - 14" OD / 17.5" Length	1 5 10 25 50	BN - Buna-N (std) VI - Viton

DGF SERIES

Vertical Dry Gas Filter

- Compact Design
- Vertical Orientation
- ASME Design

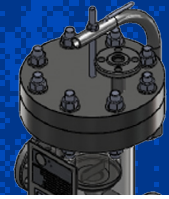

12" DGF FILTER (000) SCFH

INLET	0.5"	1"	5"	10"	20"	1	2	3	4	5
PSIG	w.c.	w.c.	W.C.	w.c	w.c	PSI	PSI	PSI	PSI	PSI
.25	67	100	246							
2	71	104	262	387	574	691				
5	75	112	283	420	624	749	1115	1403	1652	
10	87	125	316	470	699	841	1249	1569	1852	2102
20	100	150	375	558	828	995	1478	1860	2193	2489
30	117	171	429	633	941	1132	1677	2114	2489	2826
40	129	187	470	699	1041	1253	1856	2339	2755	3126
50	137	204	512	762	1132	1361	2019	2543	2997	3400
75	162	241	603	899	1332	1602	2377	2992	3525	4004
100	183	275	683	1016	1507	1810	2689	3384	3897	4528
125	204	304	753	1120	1661	1998	2968	3737	4399	4999
150	221	329	820	1215	1802	2173	3221	4058	4778	5427
200	254	375	932	1386	2060	2481	3679	4632	5456	6193
250	279	416	1041	1540	2285	2751	4083	5136	6060	6880
300	304	454	1132	1681	2493	3001	4453	5606	6605	7500
400	350	520	1299	1927	2863	3446	5111	6439	7583	8611
500	391	579	1448	2148	3188	3837	5694	7171	8449	9593
600	429	633	1582	2347	3484	4195	6222	7837	9231	10484
700	462	683	1706	2530	3758	4524	6709	8453	9956	11304
800	491	728	1823	2705	4012	4828	7163	9023	10630	12066
900	520	774	1931	2863	4249	5155	7591	9560	11262	12786
1000	549	812	2035	3017	4474	5390	7995	10068	11862	13468
1100	574	853	2131	3163	4691	5648	8378	10555	12432	14118
1200	599	891	2227	3300	4899	5898	8749	11017	12977	14733
1300	624	928	2314	3434	5094	6135	9098	11462	13502	15329
1400	649	961	2401	3563	5286	6364	9439	11891	14005	15903
1440	658	974	2435	3613	5361	6451	9573	12057	14201	16124

12" DGF FILTER (00) SCMh

INLET	1	2	5	10	20	50	100	150	250	350
BARS	mB	mB	mB	mB	mB	mB	mB	mB	mB	mB
.5	21	29	50	75	112	187	279	350	466	566
1	25	33	58	87	129	216	320	404	537	653
2	29	42	71	104	158	262	391	491	658	799
3	33	50	83	121	179	304	454	570	762	920
4	37	54	92	137	204	341	504	637	849	1028
5	42	58	100	150	221	375	554	595	932	1128
10	54	79	137	200	300	504	749	941	1261	1527
15	67	96	166	241	362	608	903	1136	1519	1840
20	75	112	187	279	412	695	1032	1303	1740	2110
25	83	125	208	312	462	774	1149	1448	1935	2347
30	92	137	229	337	504	845	1257	1582	2114	2560
40	104	154	262	391	579	974	1444	1819	2431	2947
50	117	175	291	433	645	1086	1611	2027	2714	3284
60	129	191	320	474	703	1186	1761	2218	2968	3592
70	137	204	345	512	762	1282	1898	2393	3201	3875
80	146	221	370	545	812	1369	2031	2555	3417	4141
90	158	233	391	579	862	1448	2152	2709	3621	4387
100	166	246	412	612	907	1527	2264	2855	3817	4624