

NOZZLE SCHEDULE			
MARK	QTY	SIZE / RATING	DESCRIPTION
N1	1	2" 150# NPT	INLET
N2	1	2" 150# NPT	OUTLET
N3	2	1/2" 3000# NPT	PRESSURE GAUGE
N4	1	1/2" 3000# NPT	VENT
N5	1	2" 150# NPT	SPARE

VESSEL DESIGN CONDITIONS			
CODE: BEST COMMERCIAL PRACTICE			
M.A.W.P.:	150 PSI @ 400°F	GASKET:	BUNA
M.A.W.P.:	FV PSI @ 400°F		
M.D.M.T.:	-20° F @ 150 PSI		
HYDROTEST PRESS:	195 PSI		
MATERIAL:	SS304		

NOTES:

1. VESSEL DRY WEIGHT: 68.000 LBS.
2. SHIPPING WEIGHT: 120 LBS.
3. FLOODED WEIGHT: 107 LBS.
4. VESSEL VOLUME: 0.62 CU. FT.
5. VESSEL WILL HOUSE (QTY=1) SIZE ONE SS304 BASKET

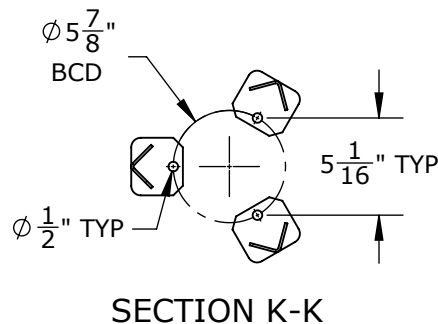
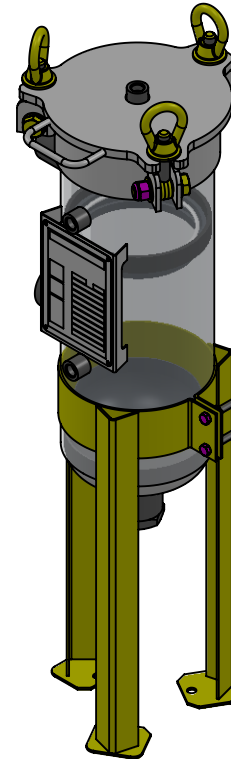
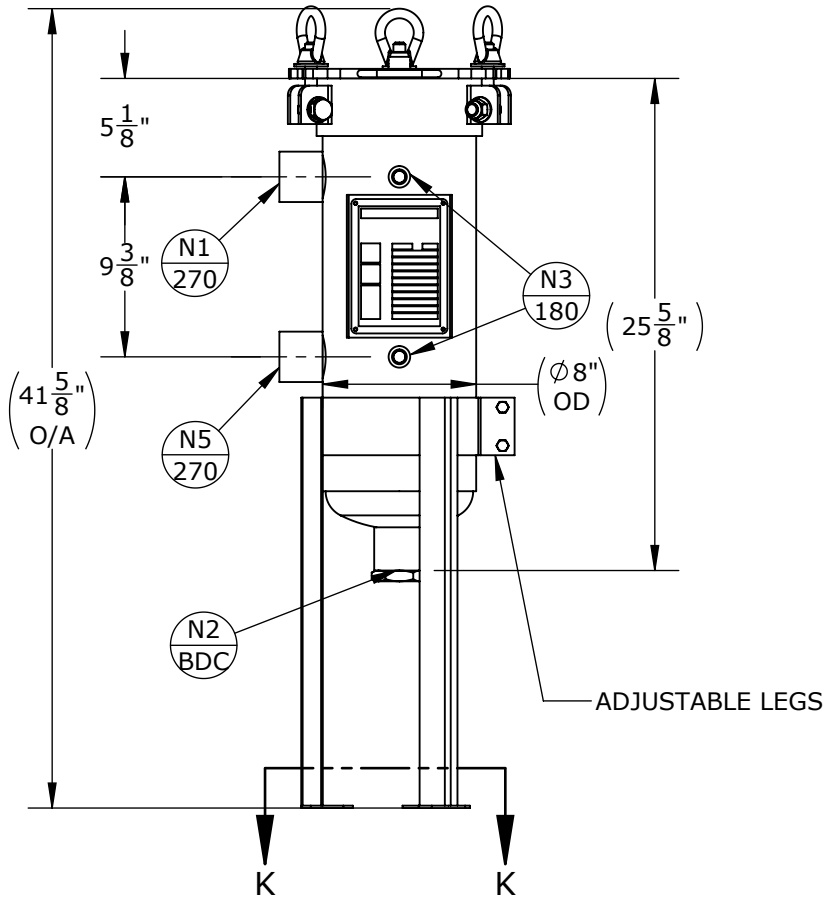

APPROVED WITH MARK-UPS APPROVED

THIRD ANGLE PROJECTION
 TOLERANCES-UNLESS OTHERWISE NOTED
 DECIMAL .X = ±.1" .XX = ±.02" .XXX = ±.005"
 FRACTIONAL = ±1/8"
 ANGULAR = ± 1°
 MAX. MACHINED SURFACE FINISH 125/√

FIL-TREK CORPORATION
 55 Stafford Court
 Cambridge, Ontario
 N1T 1B3
 Canada
 Phone: (519) 623-7448
 Fax: (519) 623-8807
 Email: info@fil-trek.com
 Website: www.fil-trek.com

THIS DRAWING IS THE PROPERTY OF 'FIL-TREK CORPORATION' AND MUST NOT BE COPIED OR USED IN ANY WAY DETRIMENTAL TO THE CORPORATION

EQUIPMENT: ESL SERIES (SINGLE BAG FILTER VESSEL)
 MODEL NO: S4ESL111-2P-CDB-150
 CUSTOMER: STOCK

PARENT: NONE	DRAWN: JG	DATE: 2024-03-07	SERIAL No.	Part No. 002001-20037	REV. No. 0
	CHK'D: TS	SCALE: NTS			