

NOZZLE SCHEDULE			
MARK	QTY	SIZE / RATING	DESCRIPTION
N1	1	4" 150# RF50	INLET
N2	1	4" 150# RF50	OUTLET
N3	2	1/2" 3000# NPT	PRESSURE GAUGE
N4	1	1/2" 3000# NPT	VENT
N5	1	2" 3000# NPT	CLEAN DRAIN
N6	1	2" 3000# NPT	DIRTY DRAIN
VESSEL DESIGN CONDITIONS			
CODE: ASME SECTION VIII DIV. 1, 2015 EDITION			
M.A.W.P.:	150 PSI @ 250°F	M.D.M.T.:	-20° F @ 150 PSI
M.A.E.P.:	15 PSI @ 250°F		
CORROSION ALLOWANCE:	NONE	HYDROTEST PRESS:	195 PSI
STAMP:	U	SERVICE:	NON LETHAL
PWHT:	N/A	RADIOGRAPHY:	N/A
MATERIAL:	SS316	GASKET:	BUNA

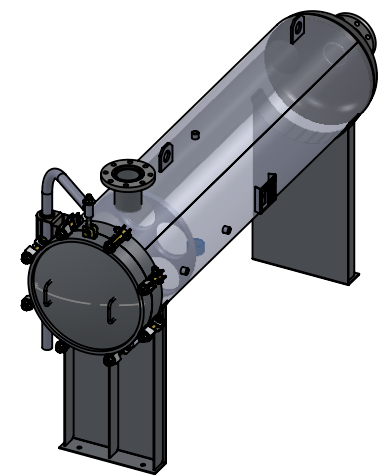

- NOTES:
- DRY WEIGHT: 504.42 LBS
 - SHIPPING WEIGHT: 800 LBS
 - FLOODED WEIGHT: 1800 LBS
 - VESSEL VOLUME: 17 C.F.
 - VESSEL WILL HOUSE (QTY=5) 6"OD x 60" ULTRA FLOW CARTRIDGES.

APPROVED WITH MARK-UPS APPROVED

THIRD ANGLE PROJECTION

TOLERANCES-UNLESS OTHERWISE NOTED

DECIMAL .X =±.1"
.XX =±.02"
.XXX =±.005"

FRACTIONAL =±1/8"

ANGULAR =± 1°

MAX. MACHINED SURFACE FINISH 125√

FIL-TREK CORPORATION

55 Stafford Court
Cambridge, Ontario
N1T 1B3
Canada

Phone: (519) 623-7448
Fax: (519) 623-8807
Email: info@fil-trek.com
Website: www.fil-trek.com

THIS DRAWING IS THE PROPERTY OF 'FIL-TREK CORPORATION' AND MUST NOT BE COPIED OR USED IN ANY WAY DETRIMENTAL TO THE CORPORATION

EQUIPMENT: ULTRAFLOW CARTRIDGE FILTER VESSEL (UFH SERIES)

MODEL NO: S6UFH20-05-60-4F-150

CUSTOMER:

DRAWN: MS	DATE: 5/25/2017	SERIAL No.	Part. No. 001012-00026	REV. No. 0
PARENT: NEW DESIGN	CHK'D:	SCALE: NTS		