

NOTES

- DRY WEIGHT: 944.74 #'S
- SHIPPING WEIGHT: 1000 #'S
- FLOODED WEIGHT: 1400 #'S
- VESSEL VOLUME: 9 C.F.
- VESSEL WILL HOUSE (QTY=66) 2.5" OD x 40" LG CARTRIDGES
- VESSEL WILL BE INTERNALLY RUBBER LINED

NOZZLE SCHEDULE			
MARK	QTY	SIZE / RATING	DESCRIPTION
N1	1	8" 150# FFSO	INLET
N2	1	8" 150# FFSO	OUTLET
N3	2	2" 150# FFSO	PRESSURE GAUGE
N4	2	2" 150# FFSO	VENT
N5	1	2" 150# FFSO	CLEAN DRAIN
N6	1	2" 150# FFSO	DIRTY DRAIN

VESSEL DESIGN CONDITIONS	
CODE:	ASME SECTION VIII DIV. 1, 2015 EDITION
M.A.W.P.:	150 PSI @ 400°F
M.A.E.P.:	15 PSI @ 400°F
CORROSION ALLOWANCE:	NONE
STAMP:	NONE
PWHT:	N/A
MATERIAL:	CS

M.D.M.T.:	-20° F @ 150 PSI
HYDROTEST PRESS:	195 PSI
SERVICE:	NON LETHAL
RADIOGRAPHY:	N/A
GASKET:	BUNA

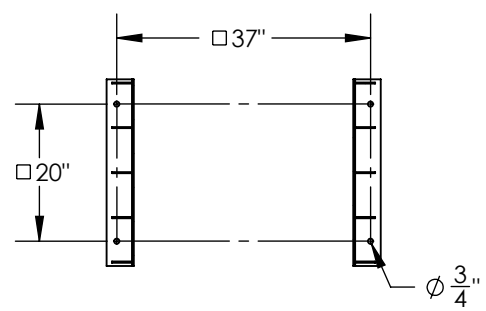
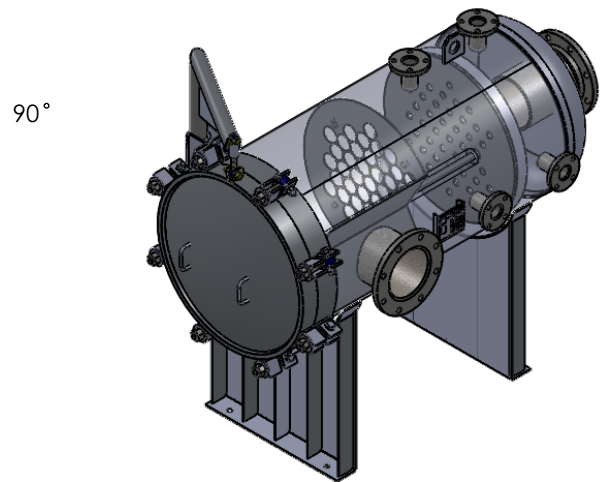
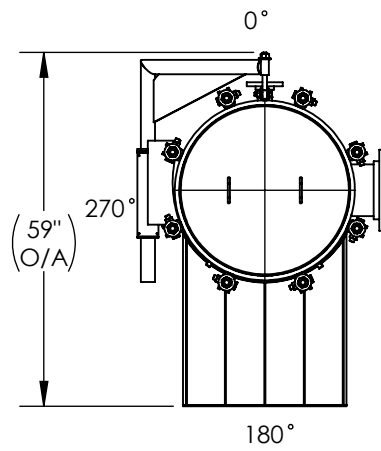
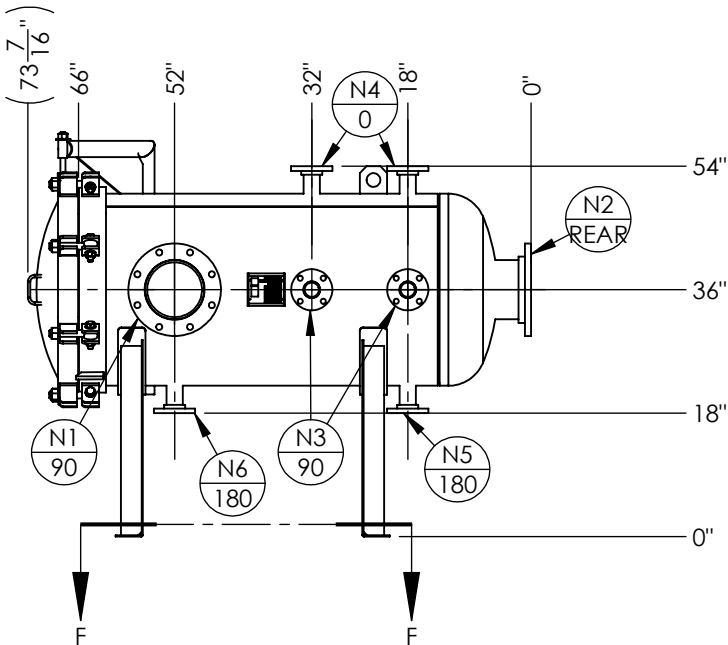

SECTION F-F
SCALE 1 : 28

APPROVED WITH MARK-UPS APPROVED

THIRD ANGLE PROJECTION

TOLERANCES-UNLESS OTHERWISE NOTED

DECIMAL .X = ±.1"
.XX = ±.02"
.XXX = ±.005"
FRACTIONAL = ±1/8"

ANGULAR = ± 1°

MAX. MACHINED SURFACE FINISH 125 ✓

FIL-TREK CORPORATION

55 Stafford Court
Cambridge, Ontario
N1T 1B3
Canada

Phone: (519) 623-7448
Fax: (519) 623-8807
Email: info@fil-trek.com
Website: www.fil-trek.com

THIS DRAWING IS THE PROPERTY OF 'FIL-TREK CORPORATION' AND MUST NOT BE COPIED OR USED IN ANY WAY DETRIMENTAL TO THE CORPORATION

EQUIPMENT: CARTRIDGE FILTER VESSEL (LH SERIES)

MODEL NO: LH28-052-4-8F-150-RL

CUSTOMER:

PARENT: NEW DESIGN	DRAWN: VD	DATE: 3/3/2017	SERIAL No.	Part. No. 001005-00007	REV. No. 0
CHK'D:	SCALE: NTS				