

SECTION P-P  
SCALE 1 : 10

NOZZLE SCHEDULE

MARK	QTY	SIZE / RATING	DESCRIPTION
N1	1	2" 3000# NPT	INLET
N2	1	2" 3000# NPT	OUTLET
N3	2	1/2" 3000# NPT	PRESSURE GAUGE
N4	1	1/2" 3000# NPT	VENT
N5	1	1" 3000# NPT	CLEAN DRAIN
N6	1	1" 3000# NPT	DIRTY DRAIN

VESSEL DESIGN CONDITIONS

CODE: ASME SECTION VIII DIV. 1, 2015 EDITION	
M.A.W.P.: 150 PSI @ 400°F	M.D.M.T.: -20° F @ 150 PSI
M.A.E.P.: 15 PSI @ 400°F	
CORROSION ALLOWANCE: NONE	HYDROTEST PRESS: 195 PSI
STAMP: UM	SERVICE: NON LETHAL
PWHT: N/A	RADIOGRAPHY: N/A
MATERIAL: SS316	GASKET: BUNA

NOTES:

- DRY WEIGHT: 45.35 LBS
- FLOODED WEIGHT: 115 LBS
- SHIPPING WEIGHT: 150 LBS
- VESSEL VOLUME: 0.25 FT<sup>3</sup>
- VESSEL WILL HOUSE (QTY=1) 2.5" OD x 20" LG CARTRIDGE

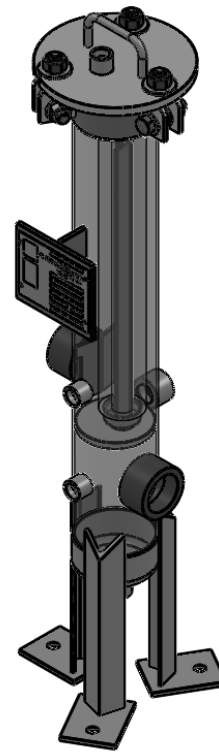

APPROVED WITH MARK-UPS  APPROVED

THIRD ANGLE PROJECTION  
TOLERANCES-UNLESS OTHERWISE NOTED  
DECIMAL .X = ±.1" .XX = ±.02" .XXX = ±.005"  
FRACTIONAL = ±1/8"  
ANGULAR = ± 1°  
MAX. MACHINED SURFACE FINISH 125/√

**FIL-TREK CORPORATION**  
55 Stafford Court  
Cambridge, Ontario  
N1T 1B3  
Canada  
Phone: (519) 623-7448  
Fax: (519) 623-8807  
Email: info@fil-trek.com  
Website: www.fil-trek.com

THIS DRAWING IS THE PROPERTY OF 'FIL-TREK CORPORATION' AND MUST NOT BE COPIED OR USED IN ANY WAY DETRIMENTAL TO THE CORPORATION

EQUIPMENT: GL SERIES (CARTRIDGE FILTER VESSEL)  
MODEL NO: S6GL04-001-2-2P-150  
CUSTOMER:

PARENT: NEW DESIGN	DRAWN: JN	DATE: 04/07/2017	SERIAL No.	Part No. 001001-00342	REV. No. 0
	CHK'D:	SCALE: NTS			