

NOZZLE SCHEDULE

MARK	QTY	SIZE / RATING	DESCRIPTION
N1	1	8" 150# RFSO	INLET
N2	1	8" 150# RFSO	OUTLET
N3	2	1/2" 3000# NPT	PRESSURE GAUGE
N4	1	1/2" 3000# NPT	VENT
N5	1	2" 3000# NPT	CLEAN DRAIN
N6	1	2" 3000# NPT	DIRTY DRAIN

VESSEL DESIGN CONDITIONS

CODE: ASME SECTION VIII DIV. 1, 2015 EDITION	
M.A.W.P.: 150 PSI @ 400°F	M.D.M.T.: -20° F @ 150 PSI
M.A.W.P.: FV PSI @ 400°F	
CORROSION ALLOWANCE: NONE	HYDROTEST PRESS: 195 PSI
STAMP: U	SERVICE: NON LETHAL
PWHT: N/A	RADIOGRAPHY: N/A
MATERIAL: SS 316	GASKET: BUNA-N

NOTES:

- VESSEL WILL HOUSE (QTY=60) 2.5"OD x 40" LG DOE CARTRIDGE.
- VESSEL DRY WEIGHT: **684.14** LBS.
- SHIPPING WEIGHT: 900 LBS.
- FLOODED WEIGHT: **1660** LBS.
- VESSEL VOLUME: **15.75** FT<sup>3</sup>

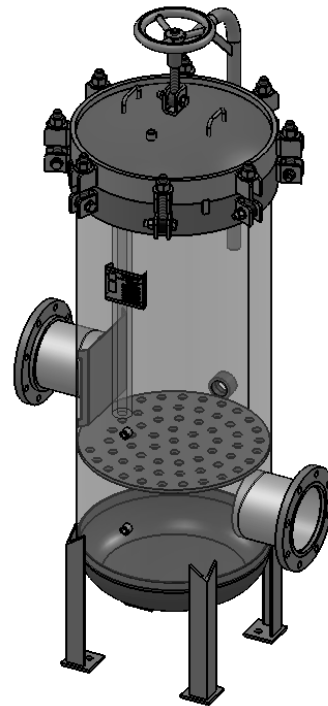

APPROVED WITH MARK-UPS  APPROVED

THIRD ANGLE PROJECTION

TOLERANCES-UNLESS OTHERWISE NOTED

DECIMAL .X = ±.1" .XX = ±.02" .XXX = ±.005"

FRACTIONAL = ±1/8"

ANGULAR = ± 1°

MAX. MACHINED SURFACE FINISH 125/√

**FIL-TREK CORPORATION**

55 Stafford Court  
Cambridge, Ontario  
N1T 1B3  
Canada

Phone: (519) 623-7448  
Fax: (519) 623-8807  
Email: info@fil-trek.com  
Website: www.fil-trek.com

THIS DRAWING IS THE PROPERTY OF 'FIL-TREK CORPORATION' AND MUST NOT BE COPIED OR USED IN ANY WAY DETRIMENTAL TO THE CORPORATION

EQUIPMENT: GL SERIES (CARTRIDGE FILTER VESSEL)

MODEL NO: S6GL24-060-4-8F-150

CUSTOMER:

PARENT: NEW DESIGN	DRAWN: JN	DATE: 19/06/2014	SERIAL No.	Part No. 001001-00149	REV. No. 0
CHK'D:	SCALE: NTS				