

NOZZLE SCHEDULE			
MARK	QTY	SIZE / RATING	DESCRIPTION
N1	1	4" 150# RFWN	INLET
N2	1	4" 150# RFWN	OUTLET
N3	1	1/2" 6000# NPT	VENT
N4	1	2" 3000# NPT	CLEAN DRAIN
N5	1	1" 3000# NPT	PRV

VESSEL DESIGN CONDITIONS	
CODE:	ASME SECTION VIII DIV. 1, 2013 EDITION
M.A.W.P.:	150 PSI @ 250°F
M.D.M.T.:	-20° F @ 150 PSI
M.A.E.P.:	15 PSI @ 250°F
CORROSION ALLOWANCE:	1/8"
HYDROTEST PRESS:	195 PSI
STAMP:	U CRN. AB/BC/SK/MN
SERVICE:	SOUR
PWHT:	1 HR @ 1100°F
RADIOGRAPHY:	RT-1
MATERIAL:	CS
GASKET:	VITON

- NOTES:
- VESSEL WILL HOUSE (QTY=1) SS-316 STRAINER BASKET 10" OD X 12" LG. (1-1/2" PERF - SUPPLIED BY OTHERS.)
  - DRY WEIGHT: 271.54 LBS
  - FLOODED WEIGHT: 450 LBS
  - SHIPPING WEIGHT: 300 LBS
  - VESSEL VOLUME: 3 C.F.
  - ALL COUPLINGS TO BE SS-316

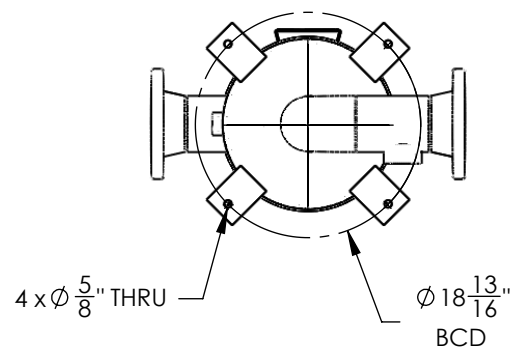
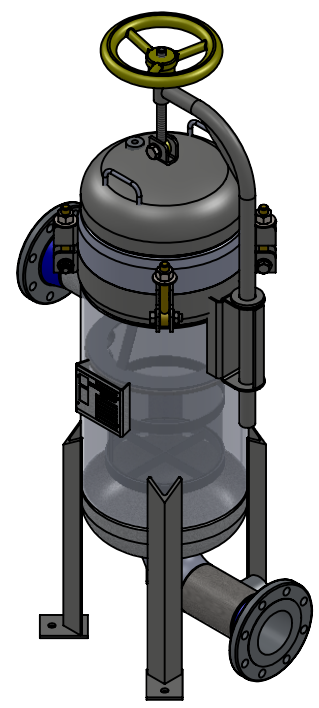
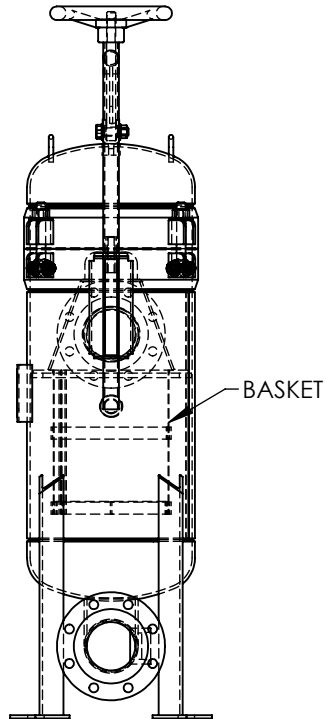
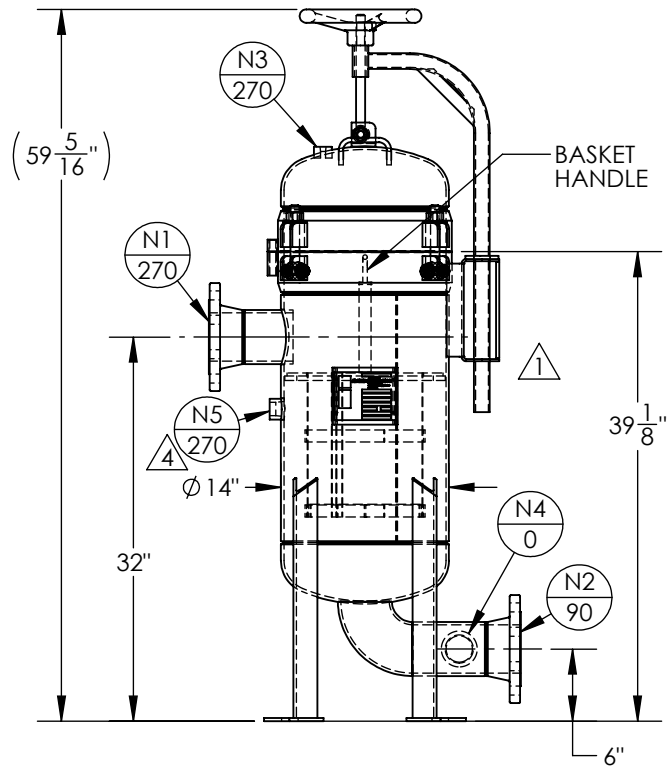

REV.	DESCRIPTION	DATE	DRW'N	APP'D
4	MOVED N5 FROM 180 DEG.	14/03/2014	JJJ	CW
3	MOVED DAVIT FROM 0 DEG. N5 FROM 90 DEG. N3 FROM 180	27/02/2014	JJJ	CW
2	UPDATED DRAWING AS PER CUSTOMERS REQUEST	19/02/2014	JJJ	CW
1	UPDATED DRAWING AS PER CUSTOMERS REQUEST	18/02/2014	JJJ	CW

<p>THIRD ANGLE PROJECTION</p>		<p><b>FIL-TREK CORPORATION</b></p>	
<p>TOLERANCES-UNLESS OTHERWISE NOTED</p> <p>DECIMAL .X = ±.1" .XX = ±.02" .XXX = ±.005"</p> <p>FRACTIONAL ≤24" = ±1/16" &gt;24" = ±1/8"</p> <p>ANGULAR = ± 1°</p> <p>MAX. MACHINED SURFACE FINISH 125/√</p>		<p>70 Fleming Drive Cambridge, Ontario N1T 2B1 Canada</p> <p>Phone: (519) 623-7448 Fax: (519) 623-8807 Email: info@fil-trek.com Website: www.fil-trek.com</p>	
<p>THIS DRAWING IS THE PROPERTY OF 'FIL-TREK CORPORATION' AND MUST NOT BE COPIED OR USED IN ANY WAY DETRIMENTAL TO THE CORPORATION</p>			
EQUIPMENT:		STRAINER BASKET VESSEL	
MODEL NO:		SBO14-1012-4F-SR-150	
CUSTOMER:		STOCK	
PARENT: V-7100	DRAWN: JJJ	DATE: 10/11/2014	JOB No. V-7550
CHK'D: CW	SCALE: NTS	DWG. No. R002762-1	REV. No. 4