

SECTION A-A
SCALE 1 : 12

NOZZLE SCHEDULE			
MARK	QTY	SIZE / RATING	DESCRIPTION
N1	1	2" 3000# NPT	INLET
N2	1	2" 3000# NPT	OUTLET
N3	2	1/2" 3000# NPT	PRESSURE GAUGE
N4	1	1/2" 3000# NPT	VENT
N5	1	1/2" 3000# NPT	CLEAN DRAIN
N6	-	-	DIRTY DRAIN

VESSEL DESIGN CONDITIONS	
BEST COMMERCIAL PRACTICE	
M.A.W.P.:	150 PSI @ 250°F
M.D.M.T.:	-20° F @ 150 PSI
M.A.E.P.:	15 PSI @ 250°F
CORROSION ALLOWANCE:	NONE
HYDROTEST PRESS:	150 PSI
STAMP:	'NC'
SERVICE:	NON LETHAL
PWHT:	N/A
RADIOGRAPHY:	N/A
MATERIAL:	SS 316/L
GASKET:	BUNA-N

- NOTES:
- VESSEL WILL HOUSE (QTY=1) DOUBLE LENGTH BASKET.
 - DRY WEIGHT: 79.05 LBS
 - FLOODED WEIGHT: 140 LBS
 - SHIPPING WEIGHT: 100 LBS
 - VESSEL VOLUME: 1.0 FT³

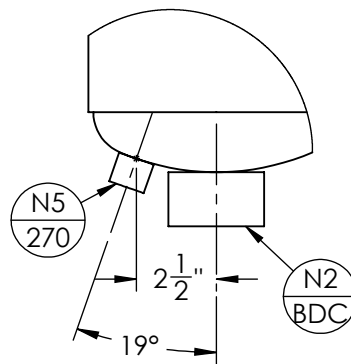

DETAIL A
SCALE 1 : 6

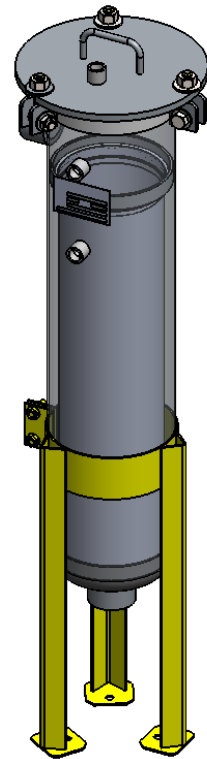

<p>THIRD ANGLE PROJECTION</p> <p>TOLERANCES-UNLESS OTHERWISE NOTED</p> <p>DECIMAL .X = ±.1" .XX = ±.02" .XXX = ±.005"</p> <p>FRACTIONAL = ±1/8"</p> <p>ANGULAR = ± 1°</p> <p>MAX. MACHINED SURFACE FINISH 125/√</p>	<p>FIL-TREK CORPORATION</p> <p>70 Fleming Drive Cambridge, Ontario N1T 2B1 Canada</p> <p>Phone: (519) 623-7448 Fax: (519) 623-8807 Email: info@fil-trek.com Website: www.fil-trek.com</p>				
	<p>THIS DRAWING IS THE PROPERTY OF 'FIL-TREK CORPORATION' AND MUST NOT BE COPIED OR USED IN ANY WAY DETRIMENTAL TO THE CORPORATION</p> <p>EQUIPMENT: BAG FILTER HOUSING (ESL SERIES)</p> <p>MODEL No: S6ESL112-2P-SW-150</p> <p>CUSTOMER: STOCK</p>				
PARENT: NONE	DRAWN: KP	DATE: 12/06/2014	JOB No. V-7279	DWG. No. 001-0158-1	REV. No. 0
	CHK'D: JJJ	SCALE: NTS			